

VersaTherm Storefront Framing

VersaTherm Storefront Framing is our most versatile and economical storefront framing system. The flexible design allows for on-site fabrication in applications ranging from punched openings to mall fronts. VersaTherm is available in a large selection of profiles. Snap-on covers and backmembers, available in a variety of colors, allow for contrasting interior and exterior finishes. Finish options and glass positioning from frame exterior to center meet a wide range of aesthetic requirements.

Snap-on covers and back members are "locked" together by a unique thermal barrier clip. This clip ensures that interior and exterior metal members remain separate while firmly connected, virtually eliminating the transference of frost and condensation. High-performance verticals and compatibility with Tubelite stock doors create a complete and truly versatile system.

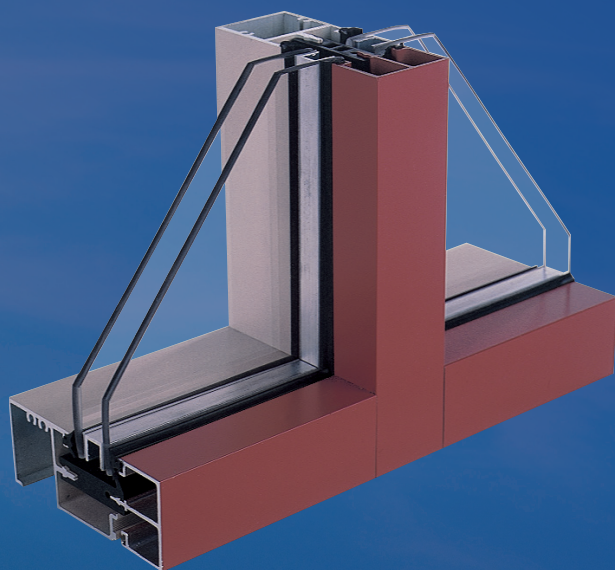

Standard Narrow
Stile Entrances

ALSO
USED
WITH



200 Series
Curtainwall

TUBELITE[®]
DEPENDABLE

LEADERS IN ECO-EFFICIENT STOREFRONT,
CURTAINWALL AND ENTRANCE SYSTEMS

VersaTherm Storefront Framing

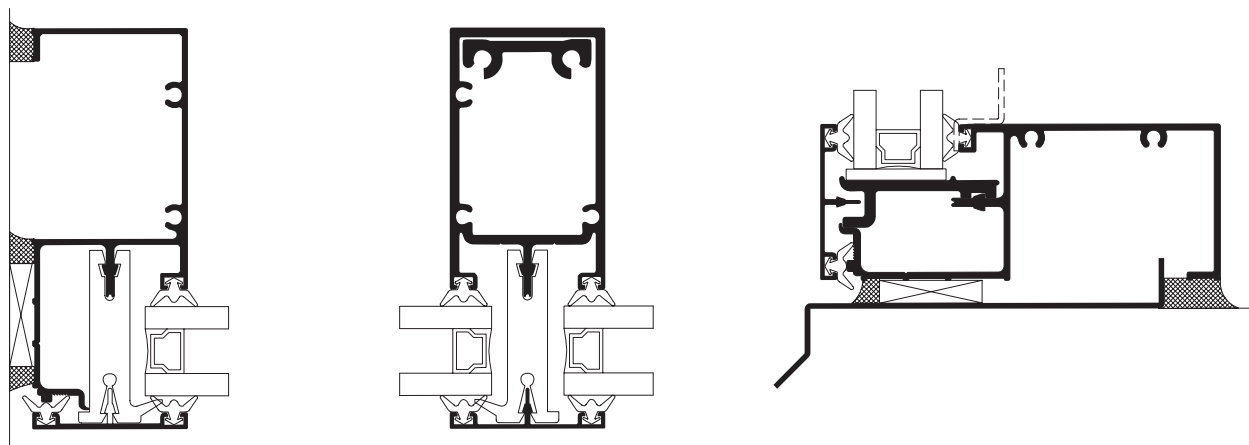

System Features:

- Standard 1-3/4" (44.45mm) sight-line on perimeter members
- 3-1/2" (88.9mm) to 6-5/8" (168.275mm) system depth
- Thermal Clip thermal break
- EPDM wedge type and fixed gaskets for 1" glass or panel thickness
- Non-thermal Framing

Optional Features:

- Screw-spline or shear block connections
- Easily integrates with standard or thermal doors and operable vent windows
- A wide variety of standard anodized and painted colors are available to complement any project with warranted protection, as well as street appeal.
- Curved Headers

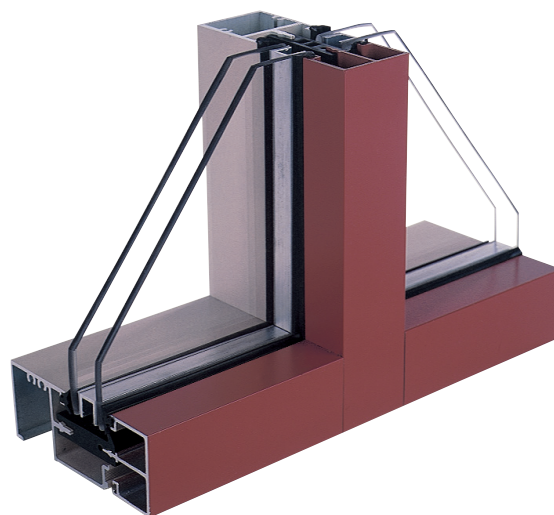

Tubelite® VersaTherm Product Specifications

Application: Low and mid-rise commercial buildings including retail, office, healthcare, schools, etc.

Description: 1-3/4" x (3-1/2" to 6-5/8") field glazed, shear block – screw spline storefront

Face Width:	Overall Depths:	Glass:	Air Infiltration:	Water Infiltration:	Structural:	U-Factor**:	CRF:
1-3/4"	3-1/2" to 6-5/8"	1" (1/4")	0.06 CFM/Ft.2 @ 6.24 PSF	12 - Static	40 PSF - Design	0.36 - Thermally Broken	64 _F 55 _C

** U-Factor per NFRC 100: COG = 0.24 with warm edge spacer, 1-3/4" x 4-1/2" non-thermal frame

Refer to the U-Factor table at: www.tubeliteinc.com/products/storefront/versatherm-storefront-framing/ for other glass makeups and configurations.

DISCLAIMER: Tubelite takes no responsibility for product selection or application, including, but not limited to, compliance with building codes, safety codes, laws, merchantability or fitness for a particular purpose; and further disclaims all liability for the use, in whole or in part, of this Technical Guide in preparation of project specifications and/or other documents. Technical Guides are subject to change at any time, without notice, and at Tubelite's sole discretion. ©2017 Tubelite Inc.

060821

TUBELITE®
DEPENDABLE

LEADERS IN ECO-EFFICIENT STOREFRONT,
CURTAINWALL AND ENTRANCE SYSTEMS

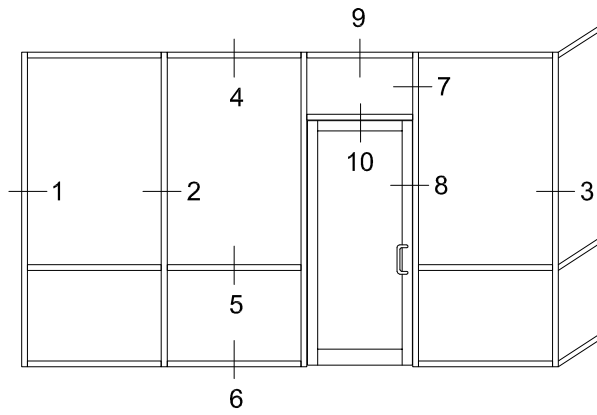

Tubelite reserves the right to change system configuration without prior notice when deemed necessary for product improvements.

Laws and building & safety codes governing the design and use of glazed entrance, window and curtain wall systems vary widely. Tubelite does not control the selection of product configurations, operating hardware or glazing materials, and assumes no responsibility thereof.

Standard Details
1/4 scale

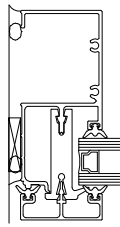

1

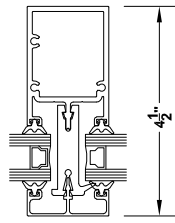

2

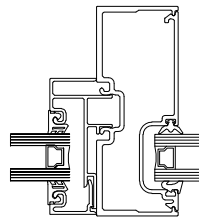

7

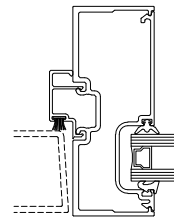

8

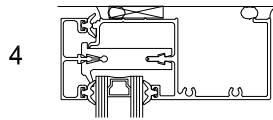

4

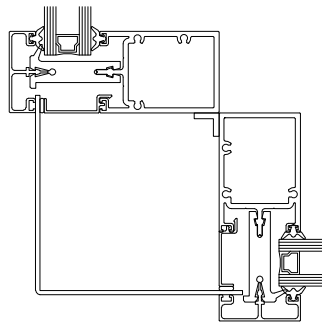

3

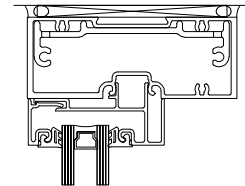

9

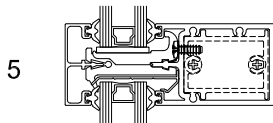

5

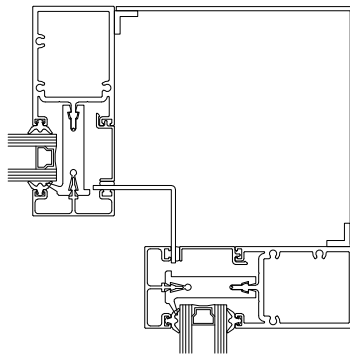

3A

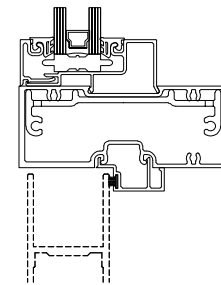

10

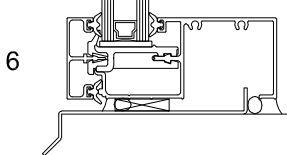

6

TUBELITE[®]
DEPENDABLE
LEADERS IN ECO-EFFICIENT STOREFRONT,
CURTAINWALL AND ENTRANCE SYSTEMS

January 2020

For specific product applications, contact your Tubelite representative.
Details on this page represent standard details found on our website.
For more options, visit our website at www.tubeliteinc.com/versatherm-storefront-framing/