

DEPENDABLE PRODUCT NEWS

TUBELITE® DEPENDABLE

LEADERS IN ECO-EFFICIENT STOREFRONT,
CURTAINWALL AND ENTRANCE SYSTEMS

Date: **11/28/16**

Engineering Bulletin: **111604**

Effective Date: 11/28/16

Released By: **Jon O'Neil**

Subject: **Steel Channel Reinforcement**

We are pleased to announce that Tubelite now offers steel reinforcement channels in multiple variations of stackable C channels to fit the projects specific needs. They are available in lengths of 12' (P6610 & P6611) and 20' (P6620 & P6621) with a Zinc chromate primer. Our Structural Engineering department will incorporate these into project reviews where necessary. Contact them for any questions.

Please note these parts have a 3 week leadtime and will ship directly from the steel supplier.

P6610		
PART #	"A" DIM	WEIGHT / FT
P6610B	2.74"	3.859
P6610C	3.27"	4.197
P6610D	4.23"	4.808
P6610E	4.58"	5.030
P6610F	5.33"	5.508
P6610G	6.33"	6.144
P6610H	7.08"	6.621

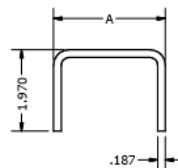

P6611		
PART #	"A" DIM	WEIGHT / FT
P6611B	2.06"	3.096
P6611C	2.59"	3.433
P6611D	3.55"	4.044
P6611E	3.83"	4.222
P6611F	4.66"	4.750
P6611G	5.66"	5.387
P6611H	6.40"	5.858

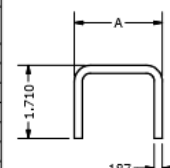

P6620		
PART #	"A" DIM	WEIGHT / FT
P6620A	1.96"	3.363
P6620B	2.74"	3.859
P6620C	3.27"	4.197
P6620D	4.23"	4.808
P6620E	4.58"	5.030
P6620F	5.33"	5.508
P6620G	6.33"	6.144
P6620H	7.08"	6.621

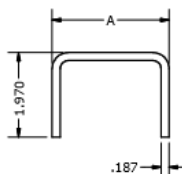

P6621		
PART #	"A" DIM	WEIGHT / FT
P6621A	1.28"	2.599
P6621B	2.06"	3.096
P6621C	2.59"	3.433
P6621D	3.55"	4.044
P6621E	3.83"	4.222
P6621F	4.66"	4.750
P6621G	5.66"	5.387
P6621H	6.40"	5.858

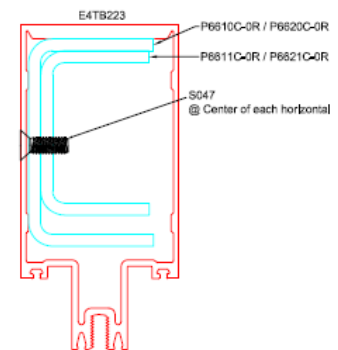
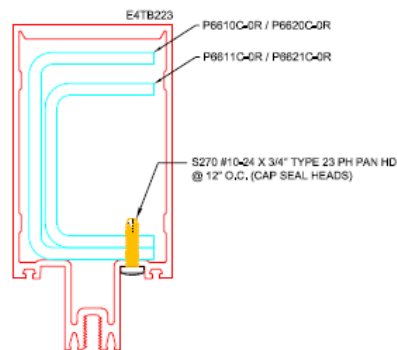
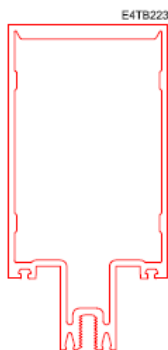
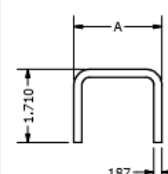

$I_{xx} = 8.457 \text{ in}^4$ $S_{xx} = 3.117 \text{ in}^3$

$I_{xx} = 15.03 \text{ in}^4$ $S_{xx} = 5.542 \text{ in}^3$